



TOP VIEW

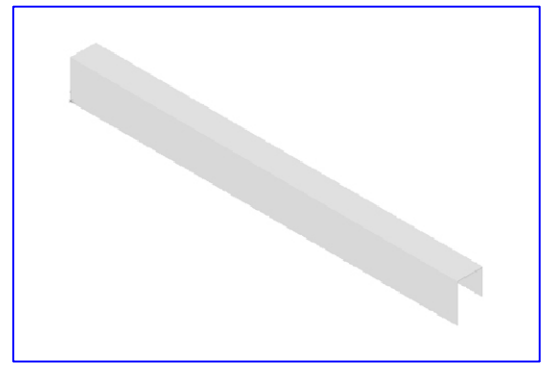
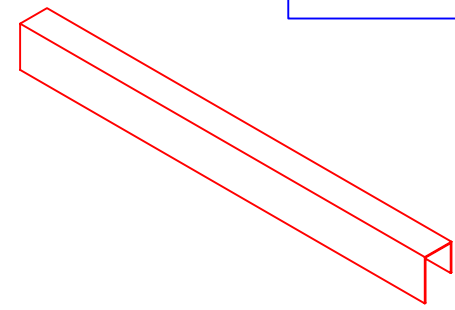
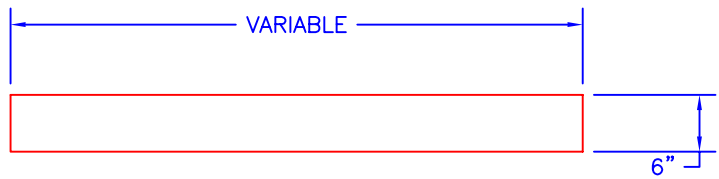

PHOTO VIEW



SIDE VIEW



FRONT VIEW

NOTES:

- 1: GEL COAT THICKNESS .020" ±.005.
- 2: 1ST LAMINATE .125" NOMINAL THICKNESS.
- 3: COMPOSITE CONSISTS OF: A) GELCOAT, B) RESIN, C) GLASS, D) FILLER

UNIT PART NUMBERS		UNLESS OTHERWISE SPECIFIED TOLERANCES ARE AS FOLLOWS			<h2 style="margin: 0;">Fiber Care Baths, Inc.</h2> <p style="margin: 0; font-size: small;">9832 Yucca Rd. Adelanto, CA 92301 Phone: 760-246-0019 Fax: 760-246-5189</p>			
RIGHT HAND UNIT	HS-RRT	DECIMAL: .XX = ±.010 .XXX = ±.005	FRACTIONAL: ±1/8"	ANGULAR: ±1/2°				
LEFT HAND UNIT	HS-RRT	CAPACITY/ OPERATING LEVEL:		GAL	TITLE THRESHOLD, REMOVABLE RIGID FIBERGLASS COMPOSITE			
<small>THE INFORMATION CONTAINED IN THIS DRAWING IS THE SOLE PROPERTY OF FIBER CARE BATHS, INC. ANY REPRODUCTION OR UNAUTHORIZED USE IN PART OR AS A WHOLE WITHOUT THE WRITTEN PERMISSION OF FIBER CARE BATHS, INC. IS STRICTLY PROHIBITED. PRODUCT CONFIGURATION, DIMENSIONS, STANDARD ACCESSORIES, MATERIALS COMPOSITION AND CONSTRUCTION ARE SUBJECT TO CHANGE WITHOUT NOTICE.</small>		CAPACITY/ OVERFLOW LEVEL:		GAL				
		APPROX. UNIT WEIGHT:		LBS	DWN	SIZE	MODEL #	REV
		APPROX. SHIPPING WEIGHT:		LBS	DATE	SCALE	PAGE	1 OF 1
					KBP	A	HS-RRT	N/C
					12/31/02	NTS		