

**TOP VIEW**

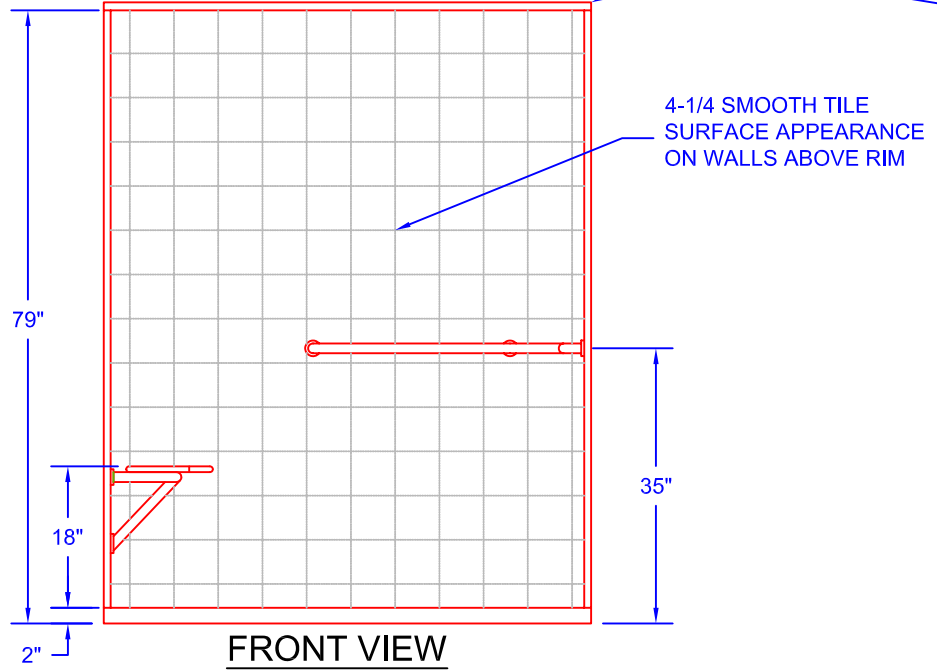

**FRONT VIEW**

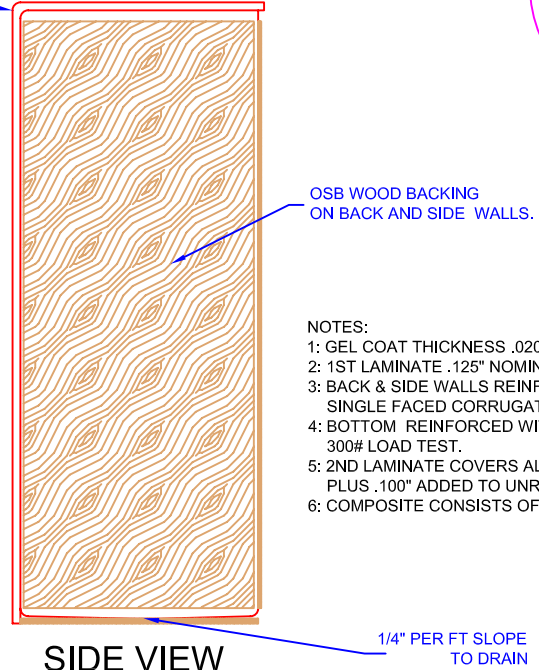

**SIDE VIEW**

- NOTES:
- 1: GEL COAT THICKNESS .020" ± .005.
  - 2: 1ST LAMINATE .125" NOMINAL THICKNESS.
  - 3: BACK & SIDE WALLS REINFORCED WITH WOOD & SINGLE FACED CORRUGATE.
  - 4: BOTTOM REINFORCED WITH WOOD TO MEET 300# LOAD TEST.
  - 5: 2ND LAMINATE COVERS ALL REINFORCEMENTS PLUS .100" ADDED TO UNREINFORCED AREAS.
  - 6: COMPOSITE CONSISTS OF: A) GELCOAT, B) RESIN, C) GLASS, D) FILLER

UNIT PART NUMBERS		UNLESS OTHERWISE SPECIFIED TOLERANCES ARE AS FOLLOWS	
RIGHT HAND UNIT	<b>HES62-31</b>	DECIMAL: .XX = ±.010 .XXX = ±.005	FRACTIONAL: ±1/8" ANGULAR: ±1/2°
LEFT HAND UNIT	<b>HES62-31</b>	CAPACITY/ OPERATING LEVEL:	GAL
<small>THE INFORMATION CONTAINED IN THIS DRAWING IS THE SOLE PROPERTY OF FIBER CARE BATHS, INC. ANY REPRODUCTION OR UNAUTHORIZED USE IN PART OR AS A WHOLE WITHOUT THE WRITTEN PERMISSION OF FIBER CARE BATHS, INC. IS STRICTLY PROHIBITED. PRODUCT CONFIGURATION, DIMENSIONS, STANDARD ACCESSORIES, MATERIALS COMPOSITION AND CONSTRUCTION ARE SUBJECT TO CHANGE WITHOUT NOTICE.</small>		CAPACITY/ OVERFLOW LEVEL:	GAL
		APPROX. UNIT WEIGHT:	LBS
		APPROX. SHIPPING WEIGHT:	LBS

<h1 style="text-align: center;">Fiber Care Baths, Inc.</h1> <p style="text-align: right;">9832 Yucca Rd. Adelanto, CA 92301 Phone: 760-246-0019 Fax: 760-246-5189</p>				TITLE	
				<b>SHOWER STALL WHEELCHAIR ACCESSIBLE</b>	
DWN	SIZE	MODEL #	REV		
KAYE	A	<b>HES62-31</b>	N/C		
DATE	SCALE	PAGE	1 OF 1		
10/29/07	<b>NTS</b>				